

5

### Placing the screen frame

- 1 - Hold the **screen frame** in the middle of the outer frame
- 2 - Stick the **steel wires** through the tightening-system at the top of the **screen frame**. Secure with the **inbus key 2mm**.
- 3 - Repeat step 2 with the **steel wires** at the bottom.

6

### Placing the facets

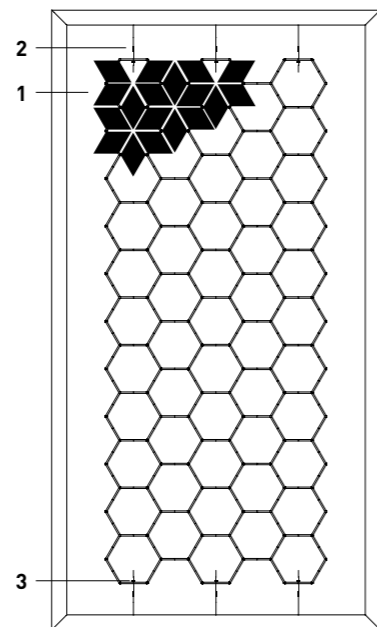

- 1 - Fill the **screen frame** with the **regular facets**. Start at the top and work your way down to the bottom.
- 2 - Don't place **regular facets** over the tightening-systems.
- 3 - When the whole **screen frame** is filled with **regular facets** you can adjust the tightening-system by turning the small wheel to place the **screen frame** with **regular facets** exactly in the middle. Don't give the screen to much tension.
- 4 - Place the **facets with wire hole** over the tightening-system on a way that the wire comes out of the hole.
- 5 - Your Facet divider is ready!

### Important!

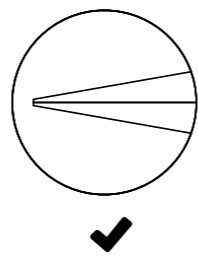
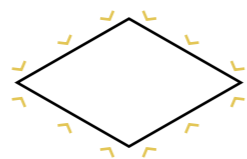
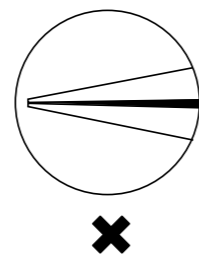

Make sure that the facets are closed over the whole side, all 12 lockpoints, otherwise the frame will not be secured and may fall apart. If a facet doesn't close properly this is occurred because a frame connection isn't closed properly.

Facet/ Lightfacet © Blooming - All rights reserved



Enjoy your Facet!



FACET

INSTALLATION GUIDE

blooming  
EINDHOVEN

# 1

## Contents

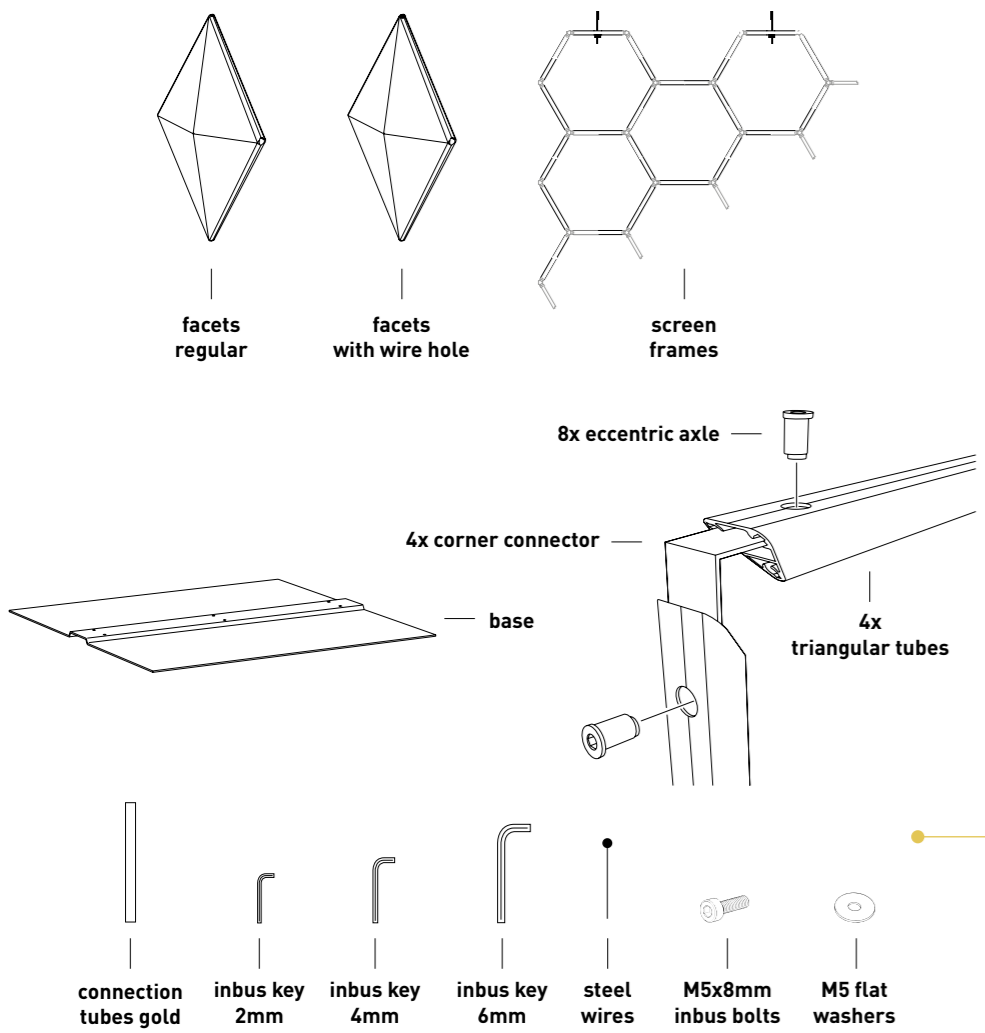

For information or questions visit:  
[WWW.BLOOMMING.COM](http://WWW.BLOOMMING.COM)

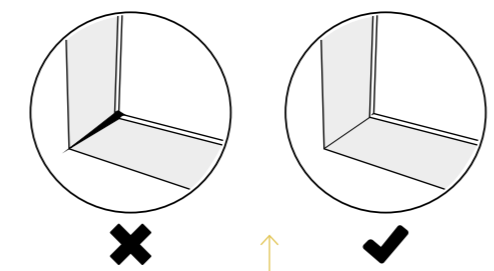

# 3

## Attaching the base

- 1 - Turn the outer frame on its side. Hold it steady so it won't fall. Use blankets so the frame won't scratch.
- 2 - Stick the **steel wires** through the frame, from the big holes on the outside through the tiny holes on the inside. Use a piece of tape to make sure they won't fall out again.
- 3 - Attach the base with the **M5x8mm inbus bolts** and **M5 flat washers** and **inbus key 4mm**.
- 4 - Rotate the rectangular frame and put it straight.

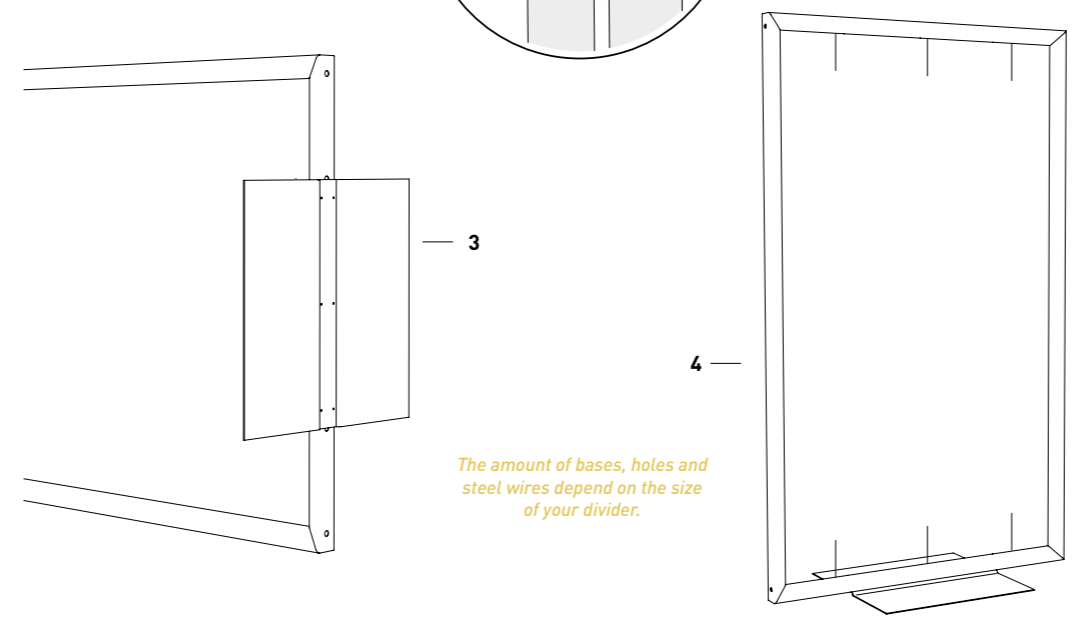
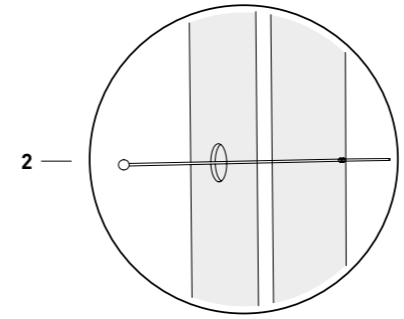
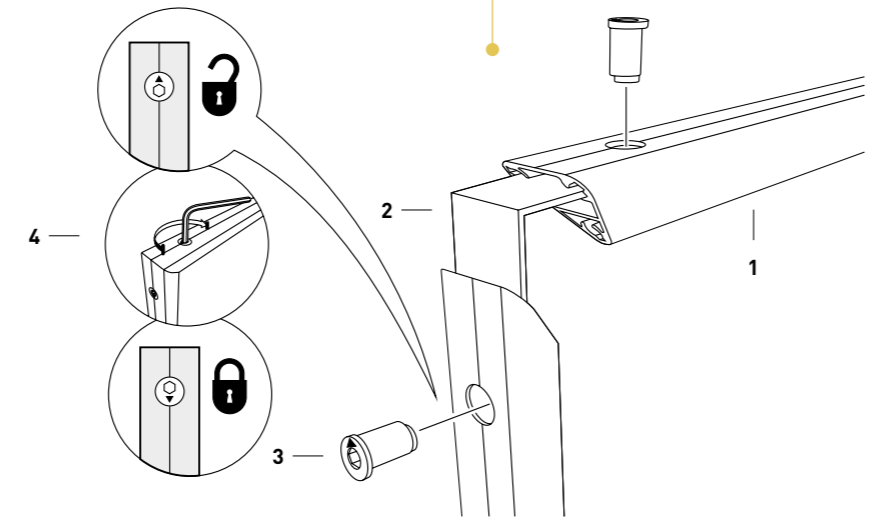

# 2

## Outer frame installation

- 1 - Place the **4 triangular tubes** in a rectangle on a flat floor. Use blankets so the **4 triangular tubes** won't scratch.
- 2 - Connect the **4 triangular tubes** with the **4 corner connectors**.
- 3 - Place the **8 eccentric axles** in the corner holes with the arrow pointing towards the corner.
- 4 - Tighten the **8 eccentric axles** evenly with the **inbus key 6mm**.

Please install this product with two or more people

# 4

## Connecting the screen frames

- 1 - Connect the **screen frames** vertical together with the **connection tubes gold**.

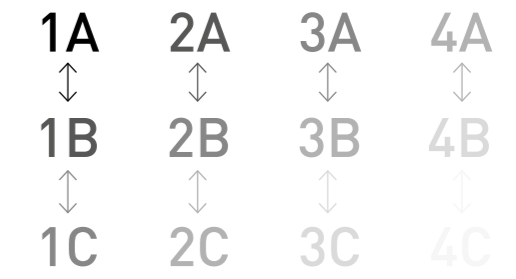

- 2 - Connect the **screen frames** horizontal together with the **connection tubes gold**.



The amount of frame parts depend on the size of your divider.

